

MOTORIZED ROLLING SHUTTER - Maxi System

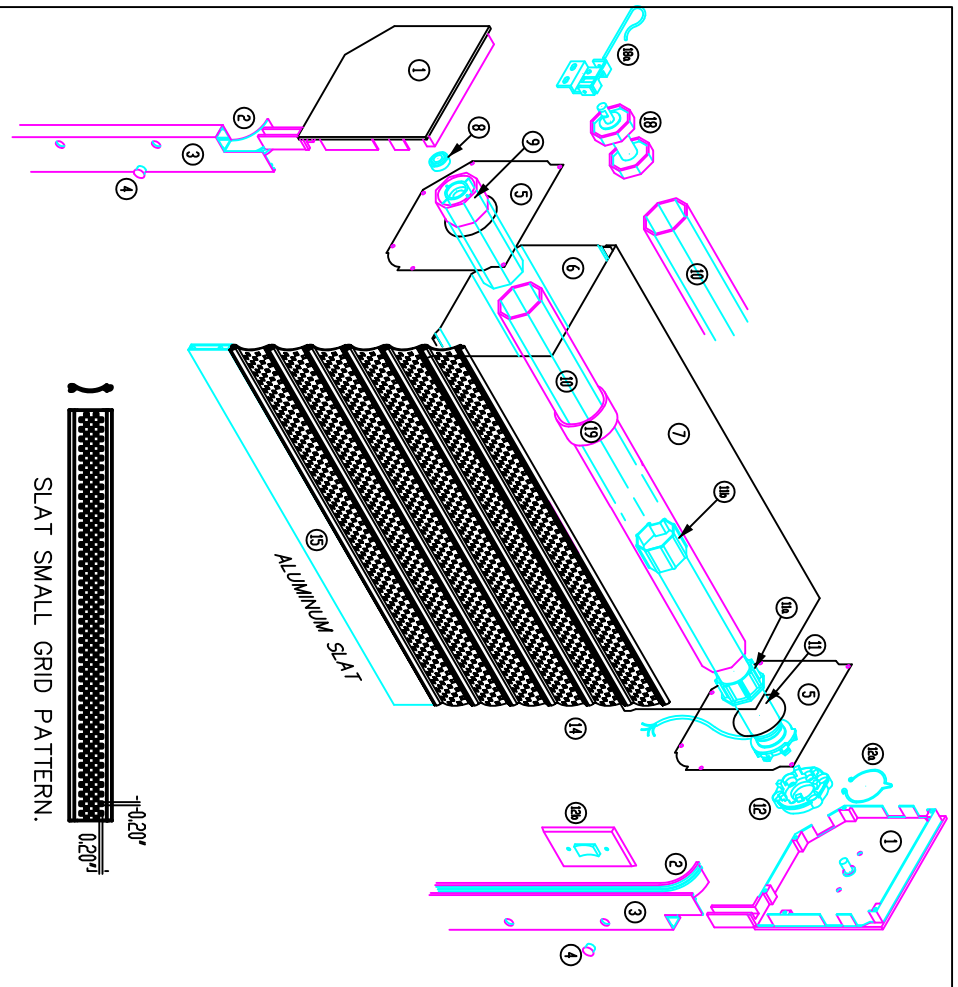

- ① Side/End Cap
- ② Entry Funnel
- ③ Side/Guide Rail
- ④ Plug Button
- ⑤ Safety Plate
- ⑥ Housing (Front/Bottom) 6'-12"
- ⑦ Housing (Top/Back) 6'-12"
- ⑧ Ball Bearing
- ⑨ Idler Insert (PVC)
- ⑩ 50/70 mm Axle (Galvanized/Aluminum)
- ⑪ Tumbler Motor
- ⑫ Crown
- ⑬ Pin
- ⑭ Motor Bracket
- ⑮ Spring Ring
- ⑯ Switch
- ⑰ Springlock Hanger
- ⑱ Base Slat
- ⑲ Idler (PVC)
- ⑳ Idler Bracket (Steel)
- ㉑ Axle Ring - PVC or Alum. (Optional)

MOTORIZED ROLLING SHUTTER MANUAL OVERRIDE OPTIONS.

<p>MANUAL OVERRIDE MOUNTED AT REAR OF SHUTTER NORMALLY GOING THROUGH WALL</p>	<p>MANUAL OVERRIDE MOUNTED ON 45 DEGREE.</p>
<p>MANUAL OVERRIDE MOUNTED AT FRONT OF ENCLOSURE</p>	<p>MANUAL OVERRIDE MOUNTED AT BOTTOM OF ENCLOSURE</p>



1-866-783-2105